

## 技术性能规范 Technical Specification

设计标准 Design & Manufacture Standard		HG/T 3704, GB/T 26114	API 609
结构长度标准 Face-to-face Dimension Standard		HG/T 3704, GB/T 12221	ASME B16.10
法兰标准 Flange Standard		HG/T 20592, GB/T 9119	ASME B16.5, JIS B2220
检验与试验标准 Inspection and Test Standard		GB/T 13927, JB/T 9092	API 598
公称通径 Nominal Diameter		DN50~DN1600	2"~64"
公称压力 Nominal Pressure		1.0MPa	1.6MPa
试验压力 Test Pressure	壳体试压 Shell Test	1.5MPa	1.5MPa
	高压密封 High Pressure Sealing	1.1MPa	1.1MPa
	低压密封 Low Pressure Sealing	0.6MPa	0.6MPa
适用温度 Temperature Range		PFA: -29°C~200°C PTFE: -29°C~180°C FEP: -29°C~150°C GXPO: -10°C~80°C	
适用介质 Applicable Medium		盐酸、硝酸、氢氟酸、液氯、硫酸、王水等强腐蚀性介质 Strong corrosive medium i.e. hydrochloric acid, Nitric acid, Hydrofluoric acid, Liquid chlorine, Sulfuric Acid and Aqua regia etc.	

特注: 衬氟阀门壳体试压和密封按照上表测试, 测试标准仅参考通用阀门标准。高压力特殊情况协商处理。  
Note: Test standard refers general valve standard, high pressure should be customized for processing.

### 氟材料压力温度曲线 Pressure-Temperature Curve

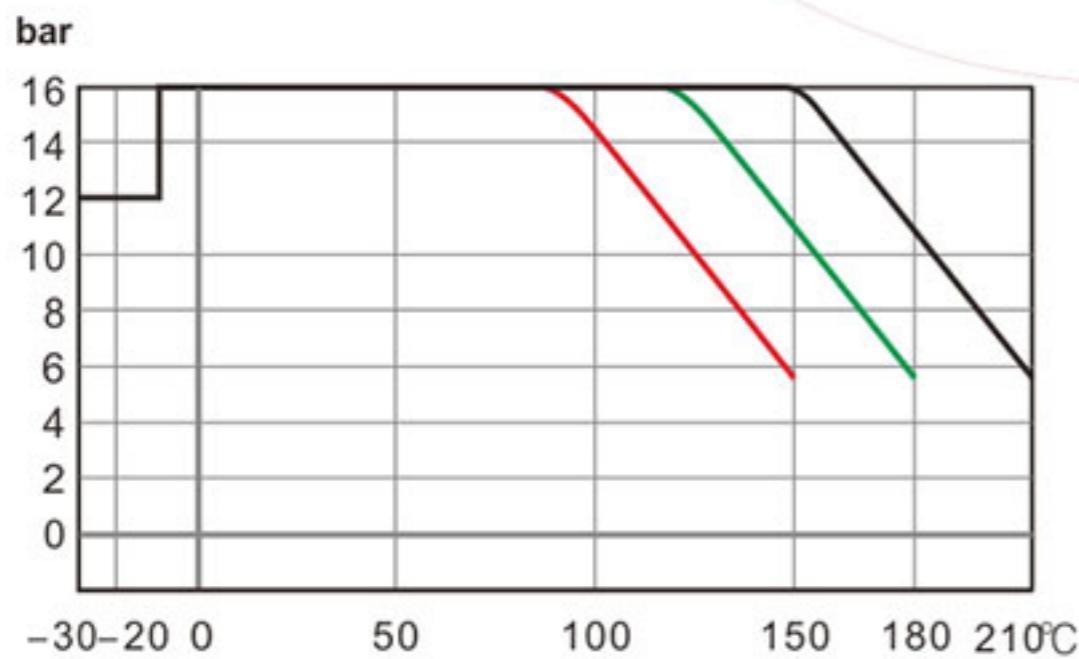

真空 Vacuum: 0.1mbar  
备注 Note: — PFA — PTFE — FEP

### 流量特性图 Flow Characteristic

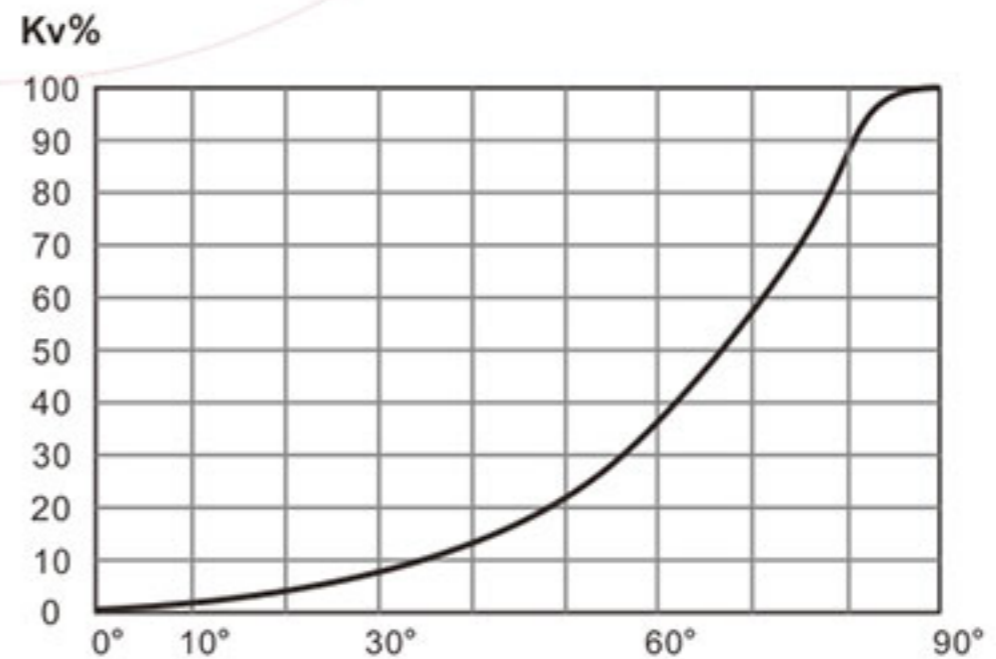

阀位角度 Valve Position Angle  
1Cv=1.167Kv



## 聚四氟乙烯衬里蝶阀结构剖视图 Cutway View For PTFE Lined Butterfly Valve

专利号 Patent No.: ZL98217159.5 ZL99333577.2

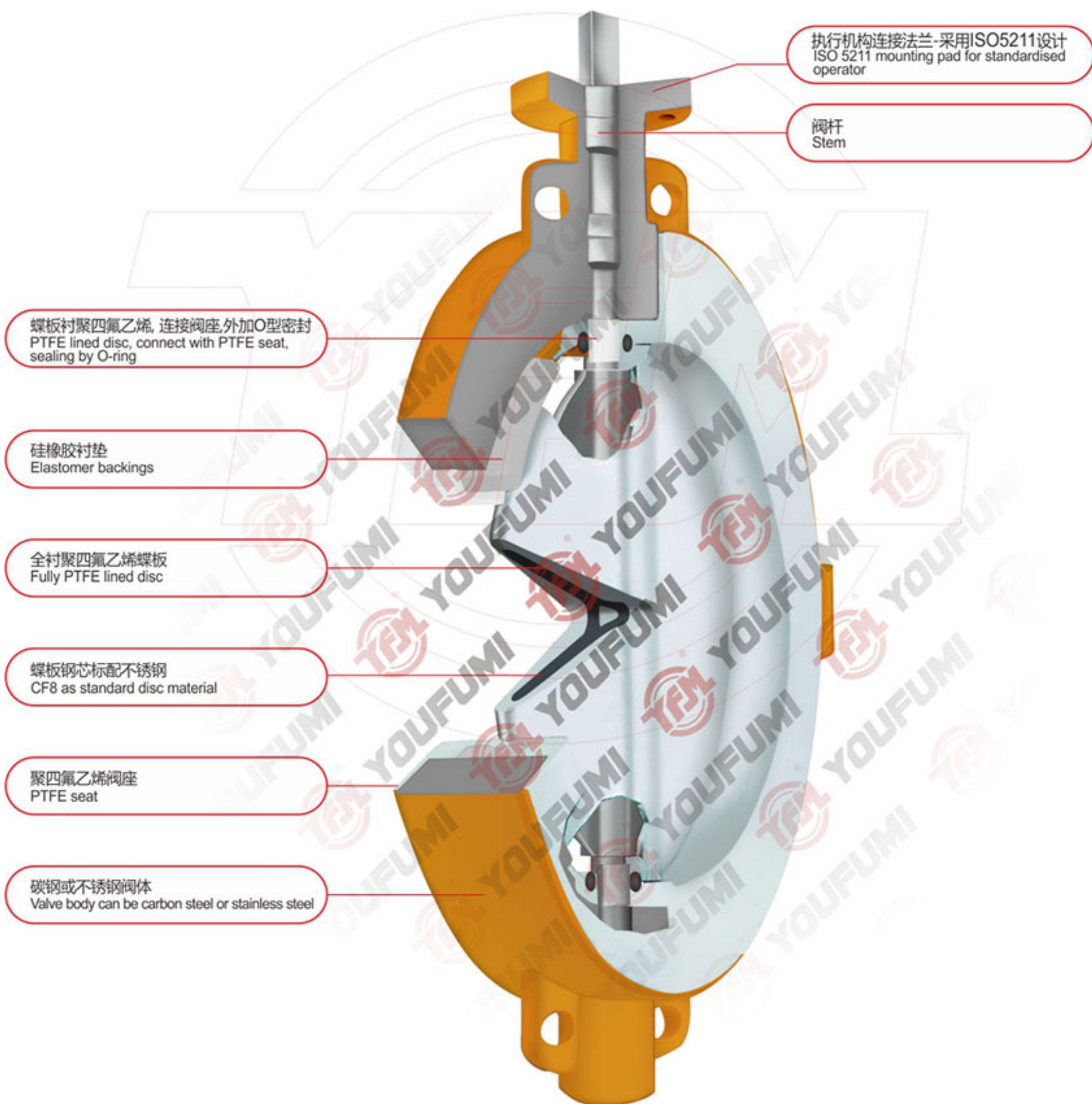



# 衬PTFE蝶阀 PTFE Lined Butterfly Valve

## 主要零件材料 Material Specification

公称通径 Nominal Diameter		DN50-DN600, 2"~24"	公称压力 Nominal Pressure		1.0MPa 1.6MPa 150LB
No.	名称 Name	材料明细 Material Lists			
1	阀体 Body	WCB	CF8/CF8M	CF3/CF3M	
2	阀杆 Stem	2Cr13(SS420) SS410 17-4PH			
3	轴套 Shaft sleeve	硅橡胶 Silicone rubber			
4	O型圈 O-ring	氟橡胶 氟橡胶+FEP 氟橡胶+PFA VITON, VITON+FEP, VITON+PFA			
5	蝶板 Disc	WCB+衬里材料 WCB+Lining material	CF8/CF8M+衬里材料 CF8/CF8M+Lining material	CF3/CF3M+衬里材料 CF3/CF3M+Lining material	
6	阀座 Seat	PTFE RPTFE			
7	弹性垫 Elastomer Backing	硅橡胶 氟橡胶 Silicone rubber, VITON			
8	内六角螺钉 Screw	A193 B7	A193 B8	A193 B8M	
9	螺栓 Bolt	A193 B7	A193 B8	A193 B8M	

## 衬PTFE蝶阀结构特点 Structure Features

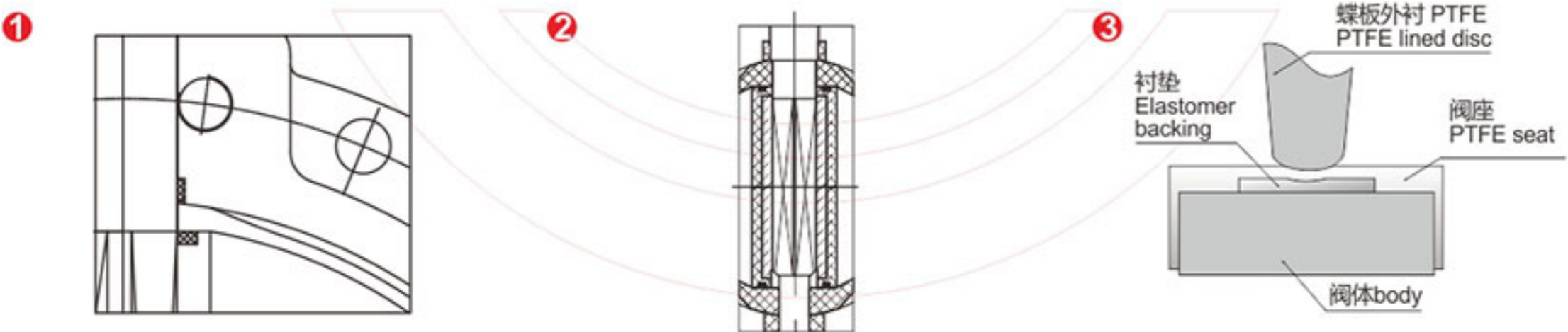

① 全衬设计结构, 与介质接触面完全采用PTFE衬层隔离, 防止金属件被腐蚀, 使阀门使用寿命更长。

Fully lined design, all the wetted parts is completely isolated by lining, totally prevent the metal parts from corrosion.

② 阀杆采用整体通杆方心设计, 保证了阀杆的强度, 减小开启间隙。

Square stem enhance the strength and reduce the opening gap.

③ 蝶板经过精加工处理, 蝶板平面尺寸的精度高, 公差范围小, 密封面是经过抛光处理的半球面, 可减小操作力矩; 通过调节上, 下阀体的连接螺栓, 可以使该组合式弹性阀座在阀体内作径向扩伸及定位, 因而在各种工作条件下均可进行调整以保持最佳密封位置。

The disc sealing face is hemispherical after polishing, to reduce the operation torque. The elastomer backing provides a resilient and uniform pressure onto sealing surface for positive tight shut-off.



主要零件材料 Material Specification

公称通径 Nominal Diameter		DN50-DN600, 2"~24"	公称压力 Nominal Pressure		1.0MPa 1.6MPa 150LB
No.	名称 Name	材料明细 Material Lists			
1	阀体 Body	WCB	CF8 / CF8M	CF3 / CF3M	
2	阀杆 Stem	2Cr13(SS420) SS410 17-4PH			
3	轴套 Shaft sleeve	硅橡胶 Silicone rubber			
4	O型圈 O-ring	氟橡胶 氟橡胶+FEP 氟橡胶+PFA VITON, VITON+FEP, VITON+PFA			
5	蝶板 Disc	WCB+衬里材料 WCB+Lining material	CF8/CF8M+衬里材料 CF8/CF8M+Lining material	CF3/CF3M+衬里材料 CF3/CF3M+Lining material	
6	阀座 Seat	PFA PTFE FEP GXPO			
7	弹性垫 Elastomer Backing	硅橡胶 氟橡胶 Silicone rubber, VITON			
8	内六角螺钉 Screw	A193 B7	A193 B8	A193 B8M	
9	螺栓 Bolt	A193 B7	A193 B8	A193 B8M	

衬PFA/FEP/GXPO蝶阀结构特点 Structure Features

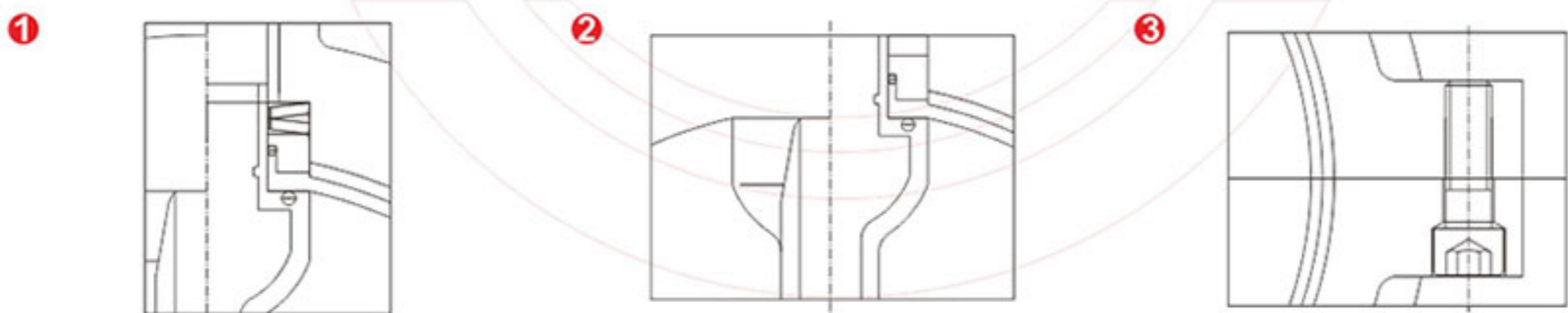

上下四道O型圈, 中间夹氟橡胶, 并结合碟形弹簧的压力作用, 氟橡胶膨胀, 增强密封性能, 解除了介质外漏。

Four O-ring with Viton in the middle, combined with the prestress transmitted from Belleville spring washer, makes Viton expands to strengthen the sealing performance.

蝶板和阀杆采用连体设计, 防止阀杆飞出、减小安装间隙。

It adopts one piece disc and stem design, which prevents the stem from blow-out to reduce the installation gap.

上体和下体采用分体结构, 内六角螺钉连接。当阀门使用时间过长, 氟塑料磨损或收缩可以调节阀体上内六角螺钉(小口径阀门留1~3mm空间来调节使用)。每次调节好后密封可以达到全新产品的同等效果。

The body is splitted and connected by hexagonal screw. When the valve operated long time, the fluorine plastic worn or shrinks, regulate the inner hexagonal screw, tighten the sealing and to achieve the equal effect of new valve (1-3mm reserved for regulation).



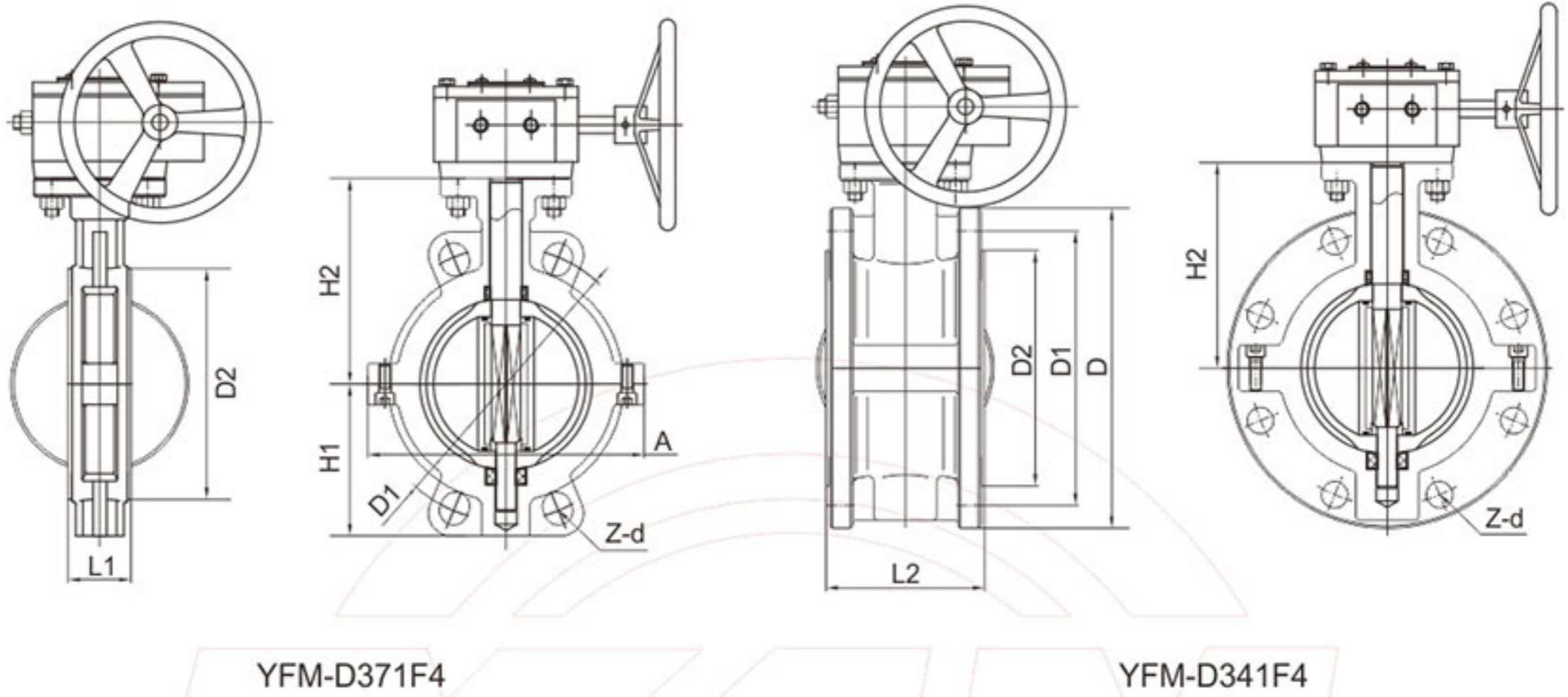

HG/T 20592

单位Unit:mm

DN	NPS	L1 对夹 Wafer	L2 法兰 Flange	PN10			PN16			D2	H1	H2	A
				D	D1	Z-d	D	D1	Z-d				
50	2	43	108	165	125	4-18	165	125	4-18	94	70	112	130
65	2½	46	112	185	145	8-18	185	145	8-18	110	80	125	150
80	3	46	114	200	160	8-18	200	160	8-18	128	90	135	160
100	4	52	127	220	180	8-18	220	180	8-18	149	105	142	180
125	5	56	140	250	210	8-18	250	210	8-18	179	120	165	215
150	6	56	140	285	240	8-22	285	240	8-22	202	133	180	242
200	8	60	152	340	295	8-22	340	295	12-22	256	172	228	295
250	10	68	165	395	350	12-22	405	355	12-26	308	205	278	356
300	12	78	178	445	400	12-22	460	410	12-26	365	235	295	405
350	14	78	190	505	460	16-22	520	470	16-26	415	260	341	466
400	16	102	216	565	515	16-26	580	525	16-30	470	290	390	495
450	18	114	222	615	565	20-26	640	585	20-30	518	320	442	630
500	20	127	229	670	620	20-26	715	650	20-33	565	355	470	670
600	24	154	267	780	725	20-30	840	770	20-36	668	420	520	825
700	28	165	292	895	840	24-30	910	840	24-36	770	500	590	895
800	32	190	318	1015	950	24-33	1025	950	24-39	875	550	650	1015
900	36	203	330	1115	1050	28-33	1125	1050	28-39	975	580	645	1115
1000	40	216	410	1230	1160	28-36	1255	1170	28-42	1080	780	670	1230
1200	48	254	470	1455	1380	32-39	1485	1390	32-48	1280	870	775	1455
1400	56	279	530	1675	1590	36-42	1685	1590	36-48	1480	980	875	1675
1600	64	318	600	1915	1820	40-48	1930	1820	40-56	1690	1100	980	1915
1800	72	356	670	2115	2020	44-48	2130	2020	44-56	1890	-	-	2115
2000	80	406	760	2325	2230	48-48	2345	2230	48-62	2090	-	-	2325

注：更多尺寸，请联系有氟密工程师。



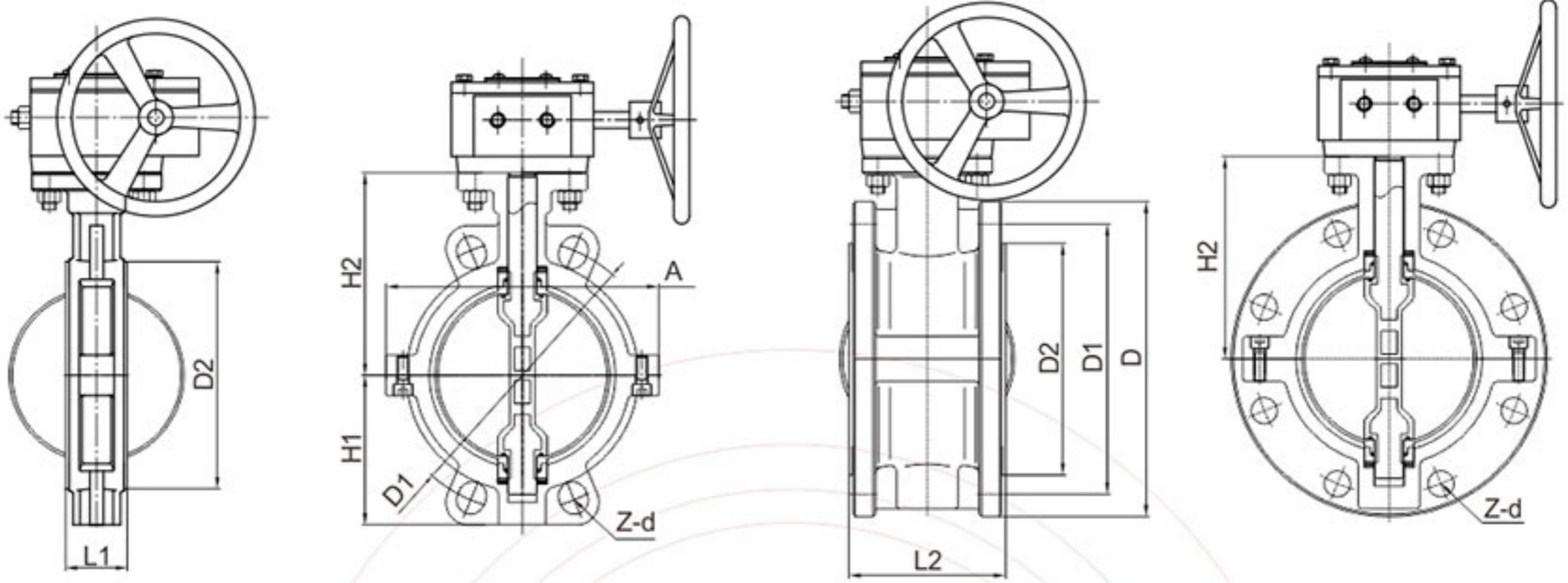

YFM-D371PFA/F46/GXPO

YFM-D341PFA/F46/GXPO

ASME B16.5 / JIS B2220

单位Unit:mm

DN	NPS	L1 对夹 Wafer	L2 法兰 Flange	ANSI 150Lb			JIS 10K			D2	H1	H2	A
				D	D1	Z-d	D	D1	Z-d				
50	2	43	108	150	120.5	4-19	155	120	4-19	94	70	112	130
65	2½	46	112	180	139.5	4-19	175	140	4-19	110	80	125	150
80	3	46	114	190	152.5	4-19	185	150	8-19	128	90	135	160
100	4	52	127	230	190.5	8-19	210	175	8-19	149	105	142	180
125	5	56	140	255	216	8-22	250	210	8-23	179	120	165	215
150	6	56	140	280	241.5	8-22	280	240	8-23	202	133	180	242
200	8	60	152	345	298.5	8-22	330	290	12-23	256	172	228	295
250	10	68	165	405	362	12-25	400	355	12-25	308	205	278	356
300	12	78	178	485	432	12-25	445	400	16-25	365	235	295	405
350	14	78	190	535	476	12-29	490	445	16-25	415	260	341	466
400	16	102	216	595	540	16-29	560	510	16-27	470	290	390	495
450	18	114	222	635	578	16-32	620	565	20-27	518	320	442	630
500	20	127	229	700	635	20-32	675	620	20-27	565	355	470	670
600	24	154	267	815	749.5	20-35	795	730	24-33	668	420	520	825
700	28	165	292	925	836.5	28-36	905	840	24-33	770	500	590	927
800	32	190	318	1060	978	28-42	1020	950	28-33	875	550	650	1060
900	36	203	330	1170	1086	32-42	1120	1050	28-33	975	580	645	1168
1000	40	216	410	1290	1200	36-42	-	-	-	1080	780	670	1289
1200	48	254	470	1510	1422.5	44-42	-	-	-	1280	870	775	1500
1400	56	279	530	1745	1651	48-48	-	-	-	1480	980	875	1746

Note: For more size, please consult our engineer.